

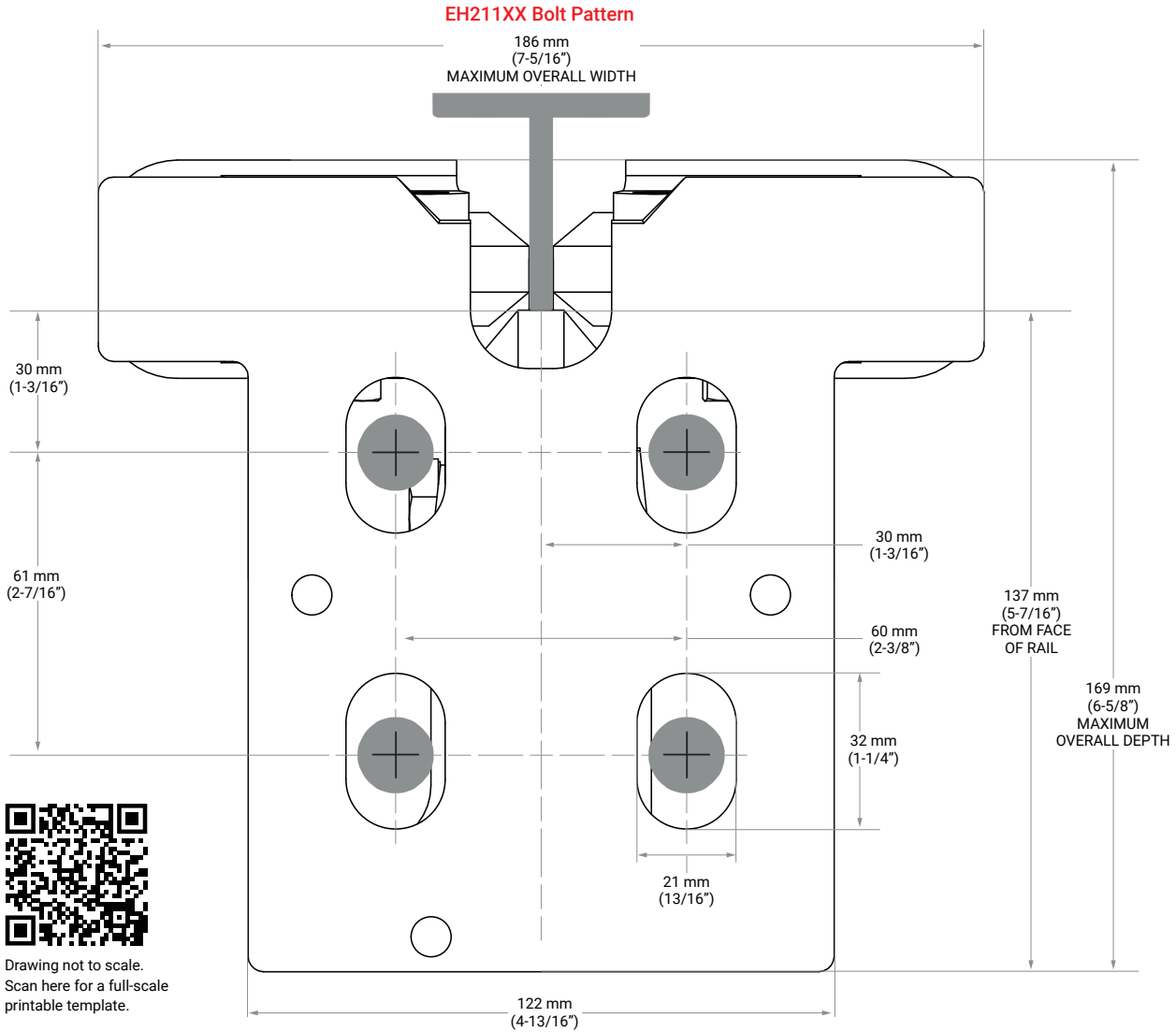

INSTALLATION AND PARTS GUIDE

MOUNTING SPECIFICATIONS



CALIBRE

C-80

Designed using quality components to deliver performance, ride quality and exceptional value

Designed for counterweights up to 3.0 m/s (600 fpm) and 1,800 kg (4,000 lbs) capacity and elevator cars up to 1.5 m/s (300 fpm) and 1,100 kgs (2,500 lbs) in low- to mid-rise buildings.

If the bolt pattern above does not line up exactly with your mounting pattern, **Flex-Mount™ Adjustable Adapter Plates** are the best time-saving, and money-saving solution. Contact us to find out more.

INSTALLATION INSTRUCTIONS

ELSCO Calibre C-80 elevator roller guides are designed for easy installation and come completely assembled from the factory, with the pre-load set on each wheel.

For optimum performance and longer roller wheel life, we recommend that elevator rails be properly aligned and cleaned, and the car balanced before operation.

ELSCO roller guides are carefully assembled, inspected, and packed to arrive in perfect condition. When your shipment arrives, inspect it carefully for damage and, if appropriate, immediately file a claim with the carrier. For best results, read all instructions thoroughly before proceeding with the installation.

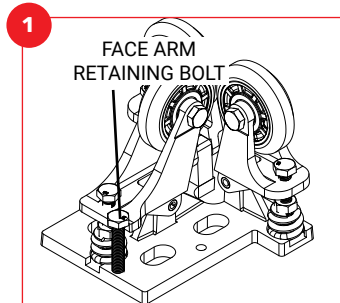

The Calibre C-80 roller guide comes completely assembled with a factory set pre-load on each wheel.

Note: Do not remove the face arm retaining bolt until the roller guide is fully installed on the mounting bolts. The pre-load on each wheel is set for the specific rail size. i.e. EH21109 is set up for a 9 mm / T70 / 0.354" rail.

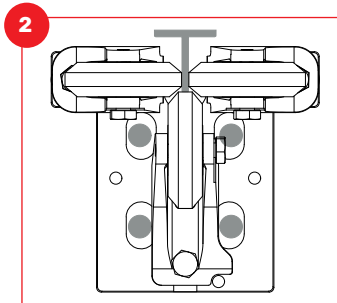

Verify the proper location of the mounting holes (refer to mounting template).

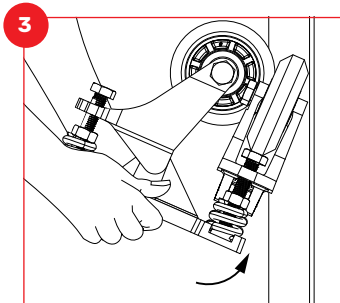

Hold the roller guide at an angle, positioning the face roller wheel onto the rail, and while maintaining pressure against the rail, roll the entire assembly upward until the side arm roller wheels engage with the rail.

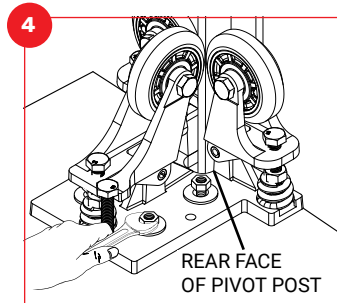

Roll guide down until positioned over the mounting holes or studs. Ensure that the front face of the rail is aligned with the rear machined face of the side arm pivot post. Install mounting hardware as required. Tighten lightly to hold bracket in place prior to final adjustment.

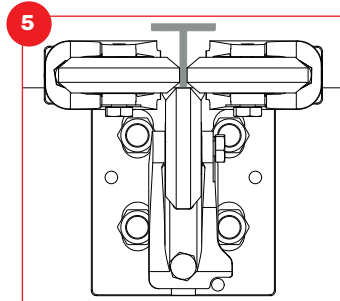

Be sure that guides are aligned properly (as shown) with the face and side roller wheels touching the rail, before making any further adjustments.

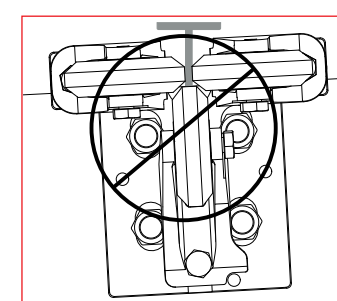

Improper alignment

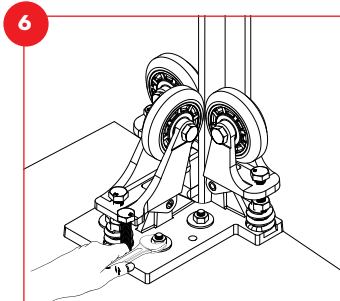

Securely tighten the mounting bolts and/or nuts. Mounting hardware is not included.

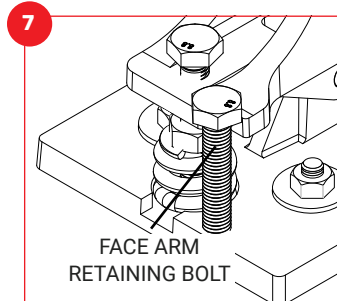

Remove the face arm retaining bolt to attain the factory set pre-load on the face arm roller wheel.

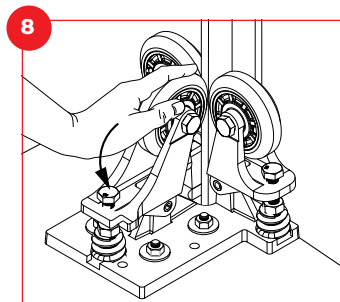

At this point, there will be 11 - 23 kg (25 - 50 lbs) of pressure on each side roller wheel and the face roller wheel, and it will be possible to skid the roller wheels by hand with moderate effort.

To ensure the elevator car will be properly centered between the rails repeat steps 3 through 8 on remaining guides before proceeding.

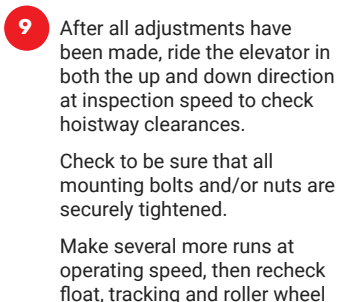

After all adjustments have been made, ride the elevator in both the up and down direction at inspection speed to check hoistway clearances.

Check to be sure that all mounting bolts and/or nuts are securely tightened.

Make several more runs at operating speed, then recheck float, tracking and roller wheel pressures before returning elevator to service.

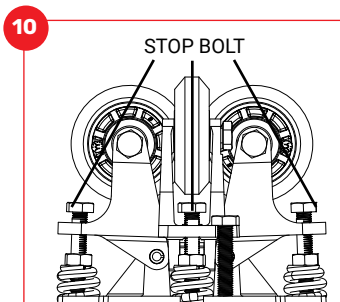

Note: This product has (3) stop bolts that are pre-set at the factory for optimized float of 3 mm (1/8") in post-to-post and back-to-front directions.

Do not adjust the stop bolts unless the float needs adjustment.

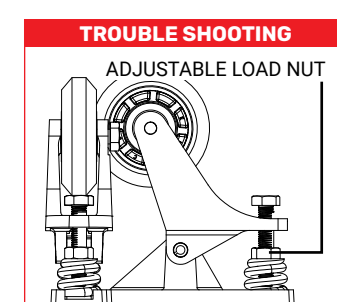

If fine tuning of the roller wheel pressure is required, proceed with the step below.

To apply more pressure to the roller wheel, turn the adjustable load nut clockwise, to release pressure on the roller wheel, turn the adjustable load nut counterclockwise.

Hold the adjustable stop bolt in place while turning load nut.

ALTERNATIVE INSTALLATION - RESTRICTED COUNTERWEIGHT/CAR FLOAT

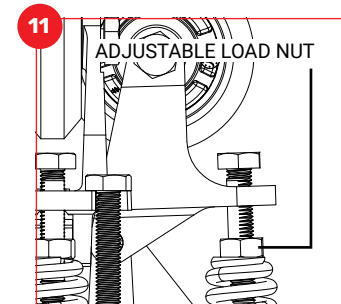

Loosen adjustable load nut on the face and side arms until the spring is no longer under compression.

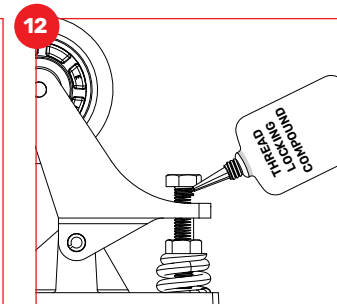

Apply thread locking compound to the adjustable stop bolt thread above the face and side arms, following manufacturer's instructions.

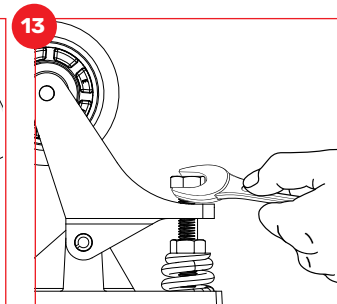

Tighten the adjustable stop bolts on the face and side arms down until they make contact with the guide base.

Test the pressure on each roller. It should be possible to skid the face and side arm roller wheels by hand with moderate effort. This represents approximately 11 - 23 kg (25 - 50 lbs) of wheel pressure on each roller wheel.

If there is too little or too much pressure loosen or tighten the adjustable stop bolt until the correct pressure is achieved.

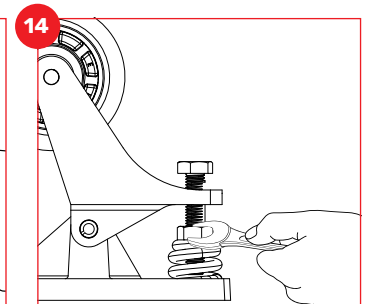

Tighten the adjustable load nuts on the face and side arms down until they make contact with the side or face arm springs and prevent them from rattling, but do not compress them.

Complete all inspections identified in step #9 before returning elevator to service.

C-80 ROLLER GUIDE SERVICE PARTS LIST

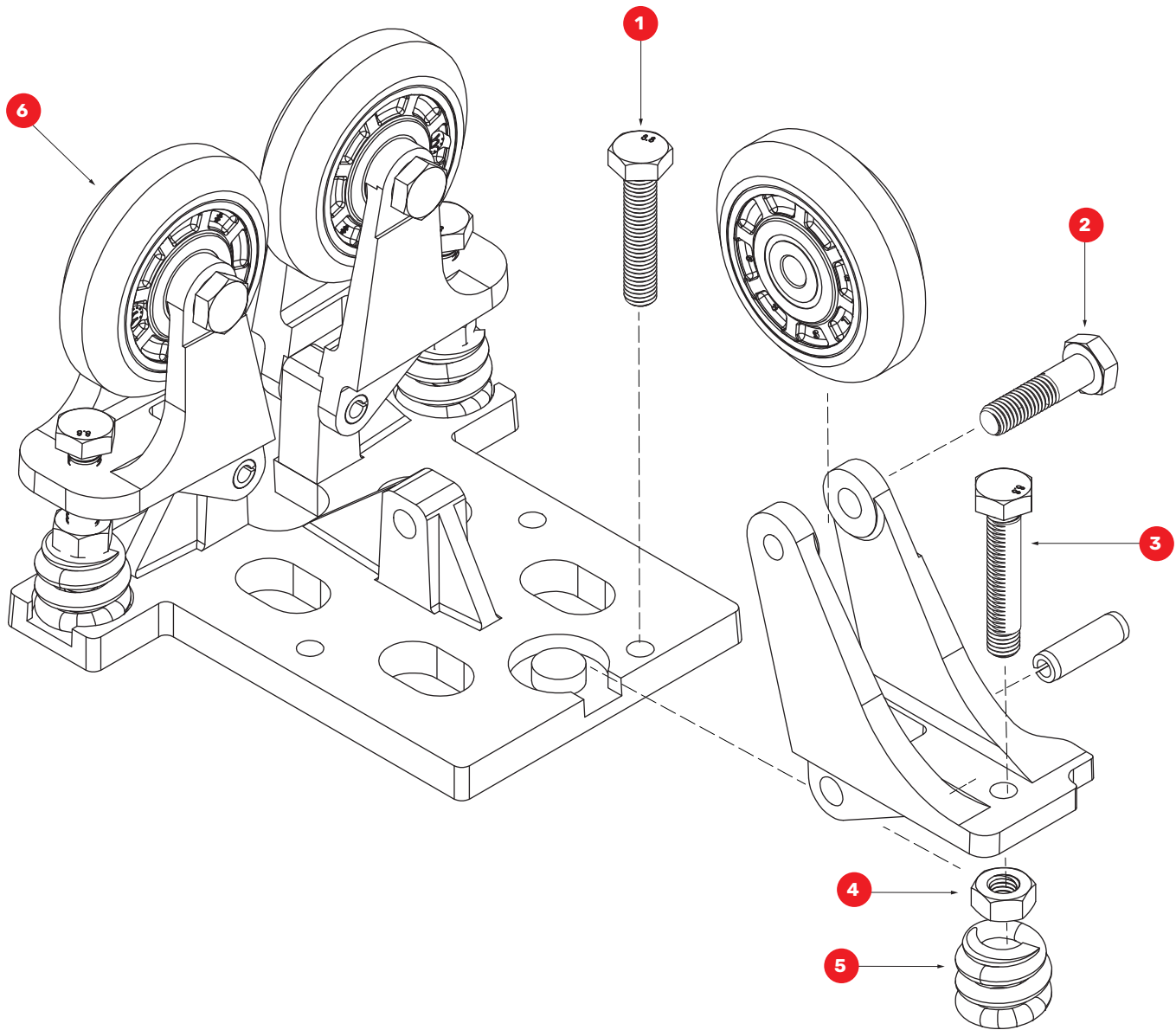

KEY	QTY	PART #	DESCRIPTION
1	1	EG24008	Face Arm Retaining Bolt
2	3	EH24008	Wheel Stud
3	3	EH24002	Adjustable Stop Bolt
4	3	EH24003	Adjustable Load Nut
5	3	EG24001	Side/Face Arm Spring
6	3	EH22080	80 mm (3.1") Polyurethane Roller Wheel