

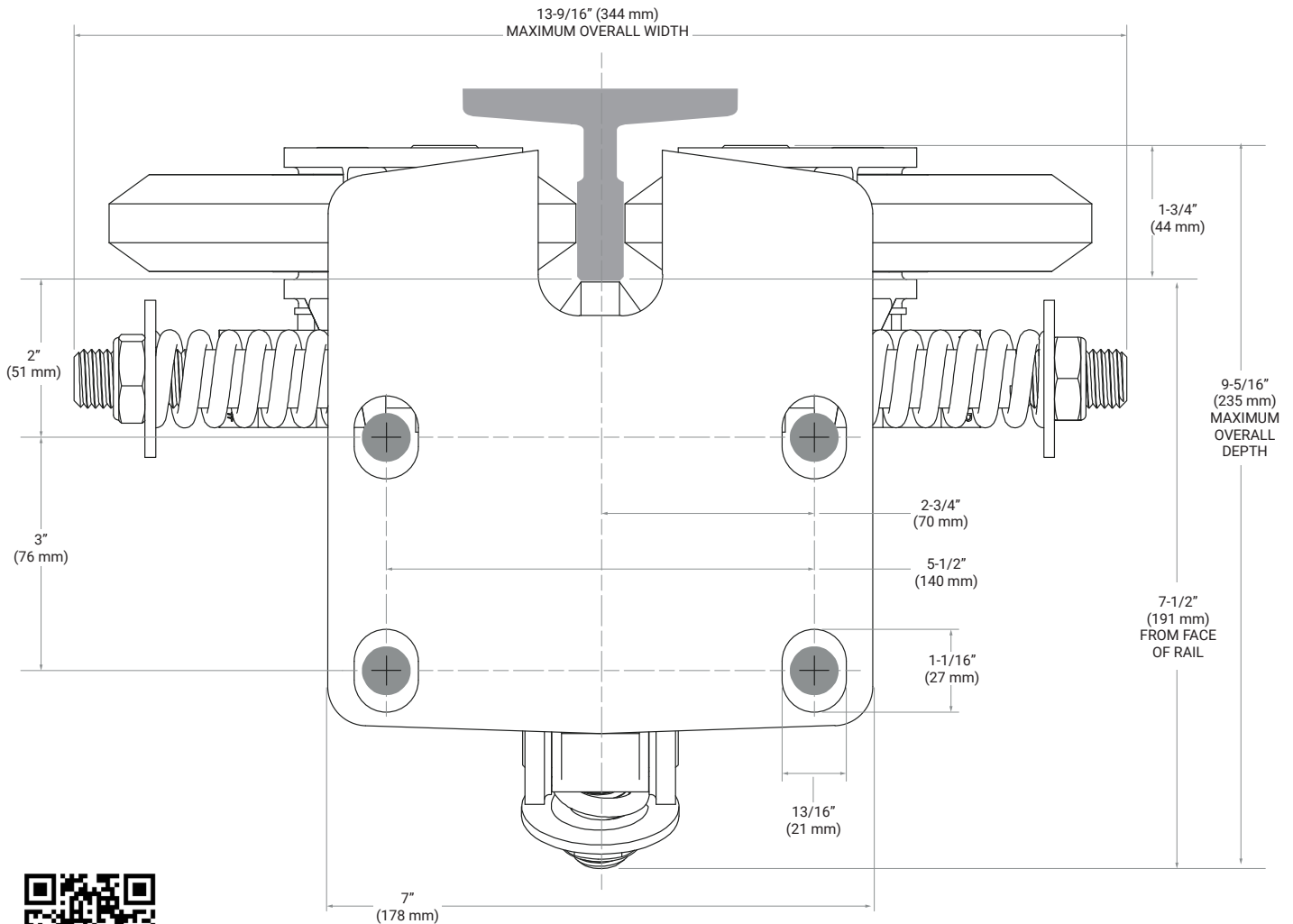

MODEL B

MOUNTING SPECIFICATIONS



Drawing not to scale.
Scan here for a full-scale
printable template

The industry's #1 choice of roller guide for elevator modernization

Designed for elevator cars up to 500 fpm and 4,000 lbs capacity in low- to mid-rise buildings.

If the bolt pattern above does not line up exactly with your mounting pattern, **Flex-Mount™ Adjustable Adapter Plates** are the best time-saving, and money-saving solution. Contact us to find out more.

INSTALLATION INSTRUCTIONS

ELSCO Model B roller guides are designed with adjustment features that provide superior riding characteristics. The installer can easily adjust ELSCO guides to compensate for adverse operating conditions and to minimize noise, bumps, and vibration. For optimum performance and longer roller wheel life, we recommend that elevator rails be properly aligned and cleaned, and the car balanced before operation.

ELSCO roller guides are carefully assembled, inspected, and packed to arrive in perfect condition. When your shipment arrives, inspect it carefully for damage and, if appropriate, immediately file a claim with the carrier. For best results, read all instructions thoroughly before proceeding with the installation.

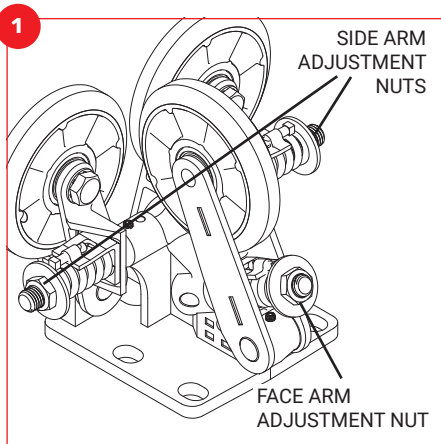

The Model B Guide comes completely assembled.

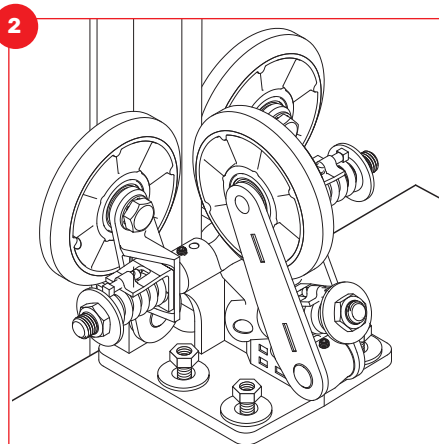

Position guide base over mounting holes or studs. Install mounting hardware (not included). Make certain that the centers of the front mounting slots are located two inches (51mm) back from the face of the rail (refer to mounting specifications).

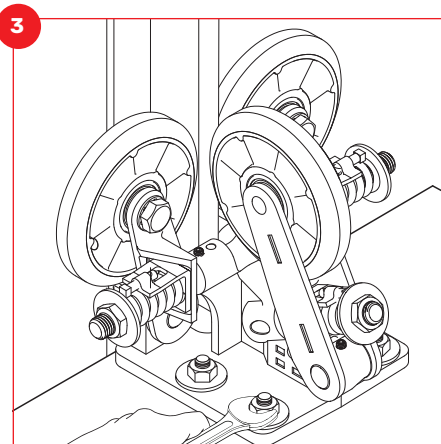

Securely tighten the mounting bolts and/or nuts. At this point, install the remaining roller guides on top and/or beneath the elevator.

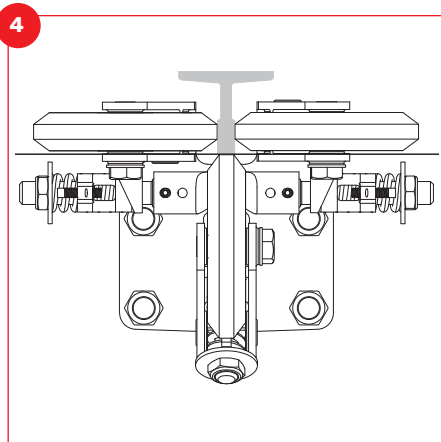

Be sure that guides are aligned properly (as shown) before making any further adjustments.

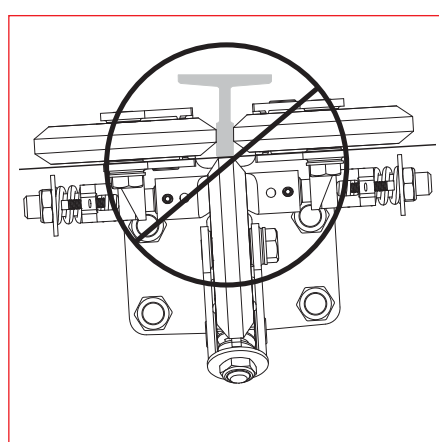

Improper alignment.

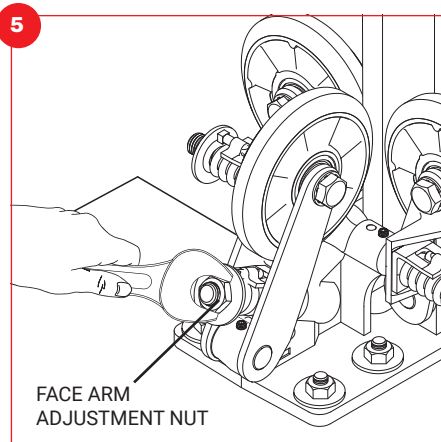

To adjust face roller wheel pressure, tighten face arm adjustment nut until the wheel is compressed $1/32'' - 1/16''$ (1-2 mm). This represents 25-50 lbs (12-25 kg) of roller wheel pressure.

Note: If guides are equipped with polyurethane roller wheels, refer to step 11 for allowable wheel pressures.

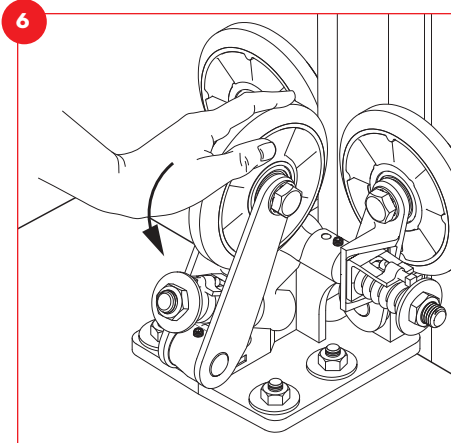

When properly adjusted, it will be possible to skid the face roller wheel by hand with moderate effort. Be certain that the face roller wheel pressures are equal for each guide.

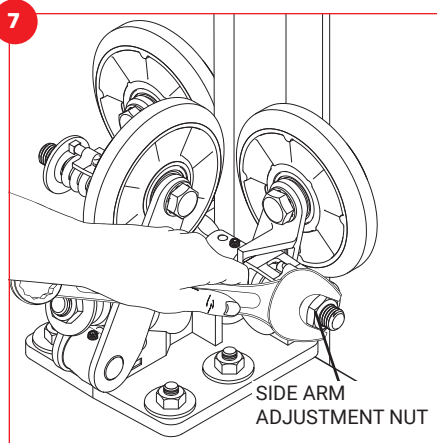

Adjust side roller wheel pressure. Turn the side arm adjustment nuts until side arm wheels are compressed 1/32" - 1/16" (1-2 mm), and the face arm wheels are tracking in the center of rail. This represents approximately 25-50 lbs (12-25 kg) of roller wheel pressure on each side arm wheel.

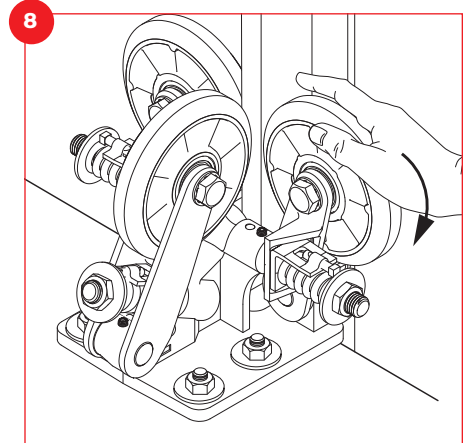

When properly adjusted, it will be possible to skid the side arm roller wheels by hand with moderate effort.

Note: If guides are equipped with polyurethane roller wheels, refer to step 11 for allowable wheel pressures.

Caution: Adjustable stops may shift during shipment. Be certain to position adjustable stops correctly, with the adjustable stop bracket positioned above the spring (as shown above).

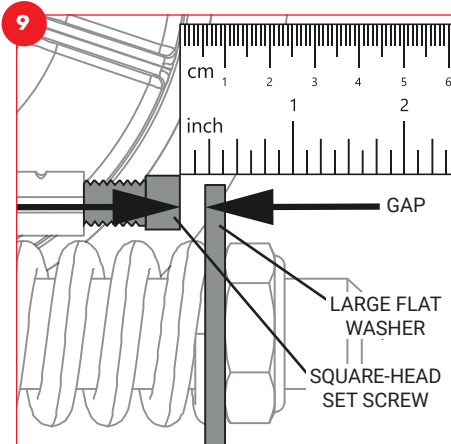

To adjust float, turn the square-head set screw to increase or decrease the gap between the large flat washer and the head of the square-head set screw.

Note: The amount of float will be approximately twice the gap measured (e.g. 1/16" gap = 1/8" float, and 2 mm gap = 4 mm float).

10 Repeat step 9 for all three adjustable stops on each guide.

If installing guides equipped with polyurethane roller wheels, refer to step 11 for pertinent information.

11 ELSCO's optional polyurethane roller wheels are made from a hard polymer material intended for use on lower speed elevators where the roller wheel pressures exceed those specified for neoprene composition wheels (25-50 lbs, or 12-25 kg). The red roller wheels have a durometer of 95 Shore A and the green roller wheels have a durometer of 80 Shore A.

While polyurethane roller wheels can operate at pressures up to 300 lbs (140 kg) per wheel, it is advisable to keep static pressure as low as possible to prevent flat spots from forming while the elevator is sitting. Flat spots can adversely affect ride quality by causing a rough and/or noisy ride. At higher pressures, it may not be possible to skid the roller wheels by hand.

12 After all adjustments have been made, ride elevator in both the up and down direction at inspection speed to check hoistway clearances. Check to be sure that all mounting bolts and/or nuts are securely tightened. Make several more runs at operating speed, then recheck float (if applicable), tracking and roller wheel pressures before returning elevator to service.

MODEL B ROLLER GUIDE SERVICE PARTS LIST

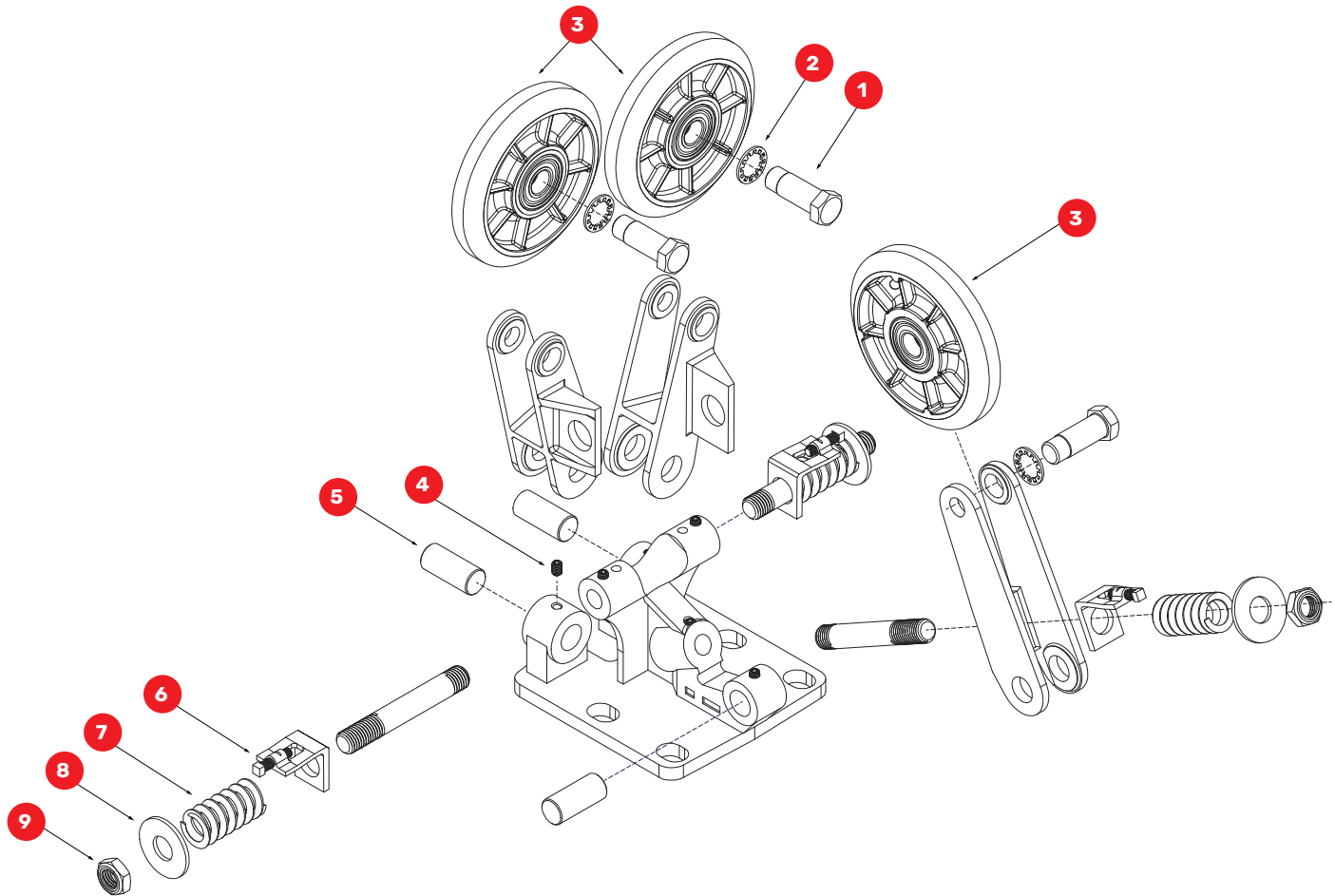

KEY	QTY	PART #	DESCRIPTION
1	3	EA18375	Wheel Stud
2	3	EA18388	Wheel Stud Lock Washer
3	3	See Roller Wheel Configuration Options	
4	6	EB02141	Set Screw
5	3	EB02106	Pivot Pin
6	3	EB02119	Adjustable Stop Kit
7	3	EA18379	Side/Face Arm Spring
8	3	EA18373	Flat Washer
9	3	EA18376	Locknut

ROLLER WHEEL CONFIGURATIONS

Typical Installations

ASSEMBLY	QTY	PART #	DESCRIPTION
EB02100	3	EA18359	6" Black Neoprene Roller Wheel

Heavy-Duty Installations

ASSEMBLY	QTY	PART #	DESCRIPTION
EB02110	3	EA18382	6" Green Polyurethane Roller Wheel
EB02114	1	EA18348	6" Red Polyurethane Roller Wheel with 1/2" tread for face arm
	2	EA18347	6" Red Polyurethane Roller Wheel with 7/8" tread for side arms
EB02220	3	EA18348	6" Red Polyurethane Roller Wheel with 1/2" tread for face and side arms