

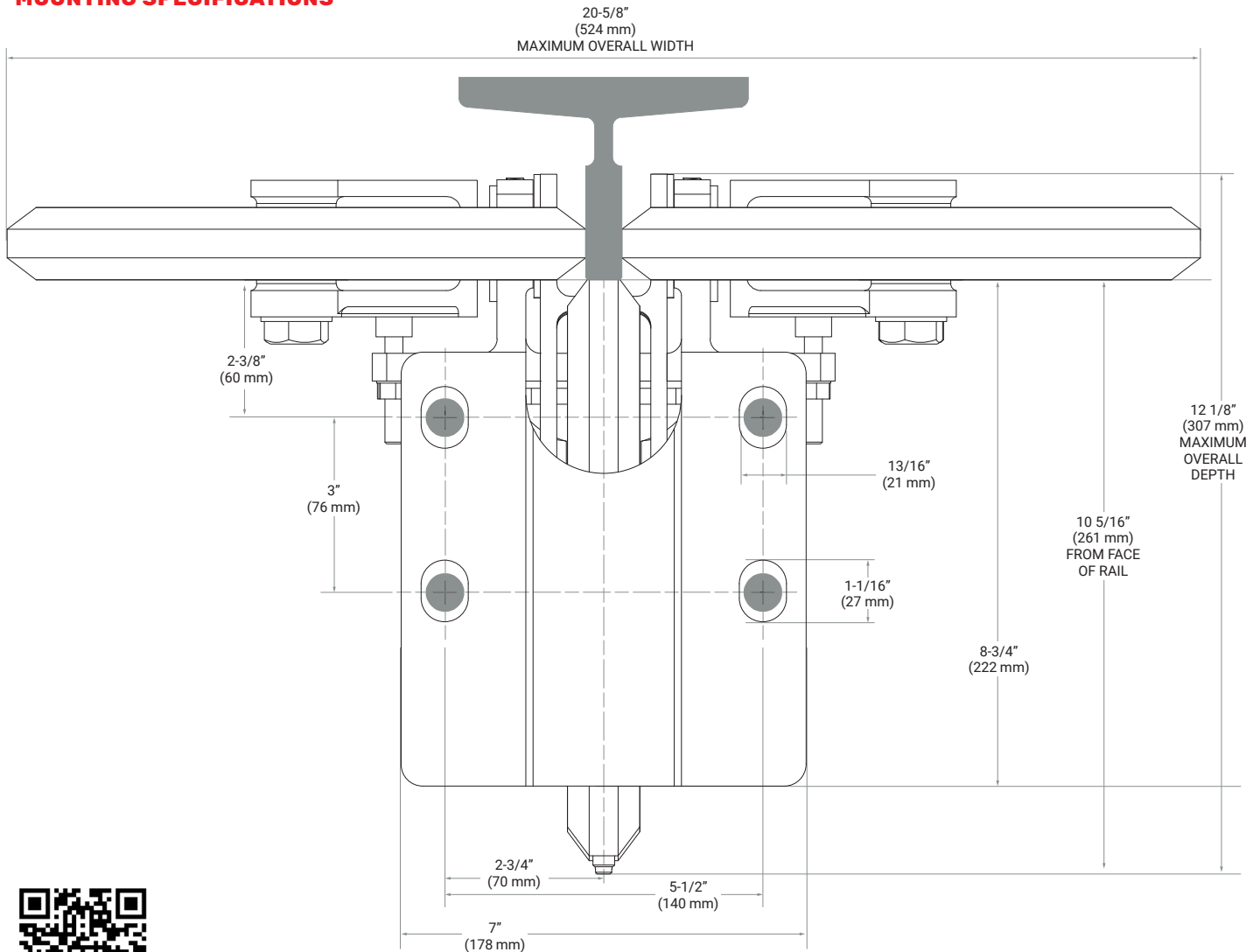

EXPRESS 6

MOUNTING SPECIFICATIONS



Drawing not to scale.
Scan here for a full-scale
printable template.

The Pinnacle of Roller Guide Performance

Designed for elevator cars up to 2,000 fpm or 6,000 lbs capacity in standard applications in high-rise buildings. Contact ELSCO Customer Service for higher-speed or more challenging load applications.

INSTALLATION INSTRUCTIONS

Engineered for use on elevators that “push the envelope,” the rugged design and heavy construction of the Express-6 make it ideal for the very fastest elevators, and those with extremely challenging loads.

1 The Express-6 Guide includes:

- › Mounting Bracket
- › Hub and Arm Assembly
- › 6 Rollers
- › 6 each Wheel Studs & Lockwashers
- › Hub Adjustment Screw Assembly
- › Spring
- › Solid Stop Washer

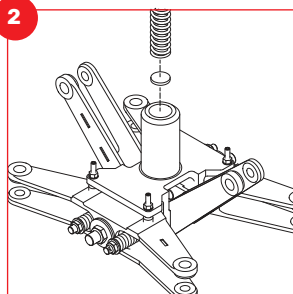

After verifying the proper location of the mounting holes, begin installation by inserting the solid stop washer into the hub. Now insert the spring into the hub. Coat the round shaft part of the hub with a light coat of grease.

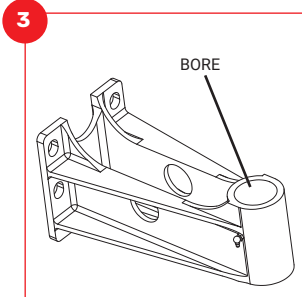

Apply a light coating of grease to the bracket bore.

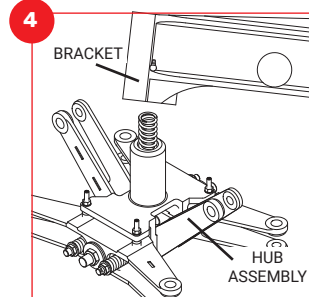

Place the bracket on the hub assembly.

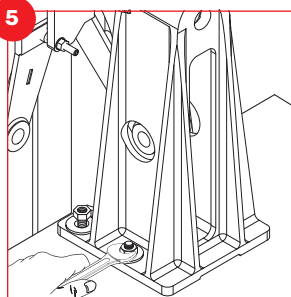

Position the hub and bracket assembly and install mounting hardware (not included) as required. Tighten lightly to hold guide assembly in place prior to final assembly.

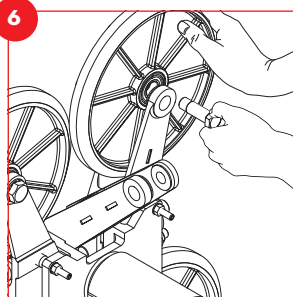

Install wheels, wheel studs and lockwashers and tighten securely.

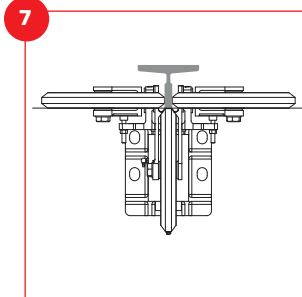

Be sure guides are aligned properly (as shown) before making any further adjustments.

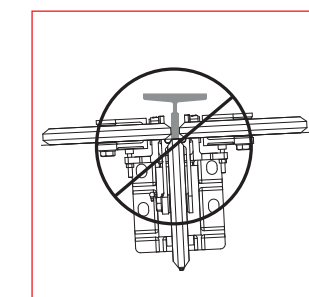

Improper alignment.

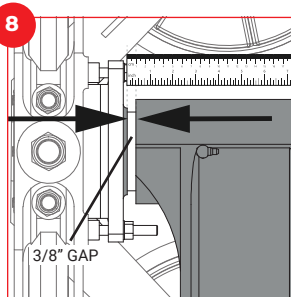

Set 3/8" gap (10 mm) between wheel cluster assembly and bracket.

Note: Be certain that both face roller wheels are firmly seated against the rail while making this adjustment.

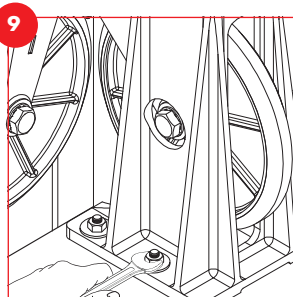

Tighten mounting bolts securely. At this point, install the remaining roller guides on top and/or beneath the elevator. Lubricate the fitting on each guide with general purpose grease until a small amount appears between the hub and the bracket.



Install the hub, hub adjustment screw assembly and nut into bracket. Adjustment of the large screw regulates the pressure of the face roller wheels against the rail.

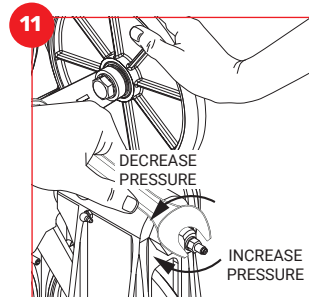

Turn the large hub adjustment screw until roller wheel tire is compressed 1/32" - 1/16" (1-2 mm) on the rail. This represents approximately 25-50 lbs (12-25 kg) of wheel pressure.

Note: If installing guides equipped with polyurethane roller wheels, refer to step 21 for allowable wheel pressures.

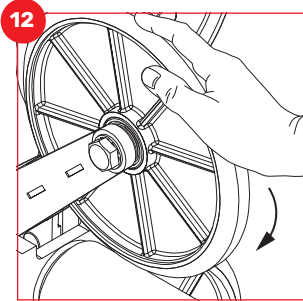

When properly adjusted, it will be possible to skid the face roller wheel by hand with moderate effort.

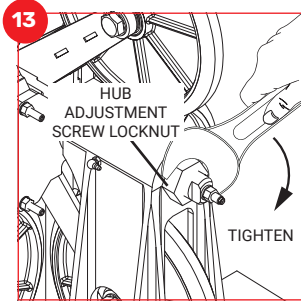

Be certain that both, face roller wheel pressure and recommended gap measurement (see step 8) are equal for each guide.

Caution: This gap measurement may now be greater than 3/8" (10 mm), but should never exceed 1/2" (12 mm).

Now, tighten hub adjustment screw locknut.

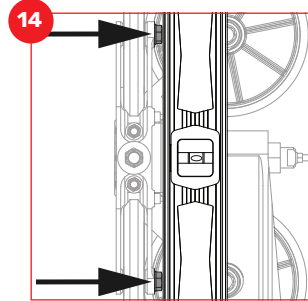

Each pair of side arm rollers should track parallel to the rail. To check tracking, place a level on the wheel stud heads or the machined surfaces where the tracking screw pads contact the arm, adjust if necessary (see figure 15).

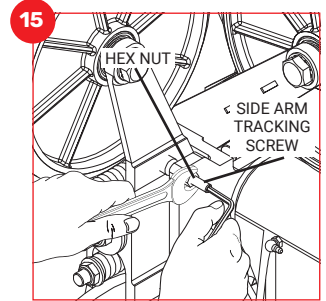

If it is necessary to adjust the side arm tracking, first loosen the hex nut. Next securely hold the hex nut with a wrench while using a 5/32" hex key to adjust the position of the tracking screws until top and bottom roller wheels are parallel to the face rail. Now tighten the hex nut down against the hub.

Note: If adjusted correctly, tracking screws should not restrict float or walking beam action of side arm assembly.

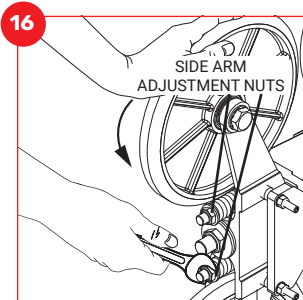

To adjust the side arm roller wheel pressure, turn side arm adjustment nuts until the roller wheels are compressed 1/32" - 1/16" (1-2 mm). This adjustment also controls the centering and tracking of the face arm rollers (see figure 17).

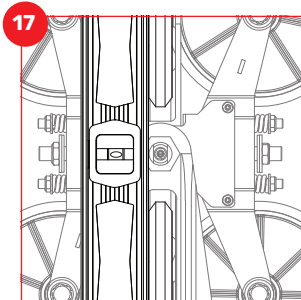

Check the face where the roller contacts the rail or use a level. The face rollers should also be centered on the rail.

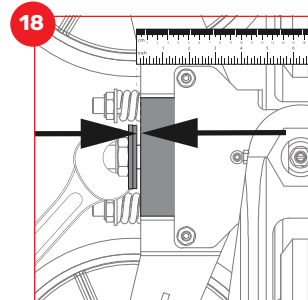

Set the positive stop to the recommended 1/8" (3 mm) gap.

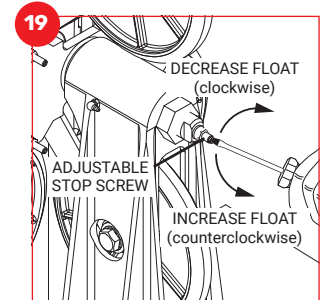

To set postwise float, turn adjustable stop screw clockwise until it makes contact with solid stop washer (installed in step 2). At this point, there will be zero postwise float. To increase float, turn adjustable stop screw counter-clockwise.

Note: Each full turn equals 1/16" (2 mm). For best results, set the float at 3/16" - 5/16" (5-8 mm).

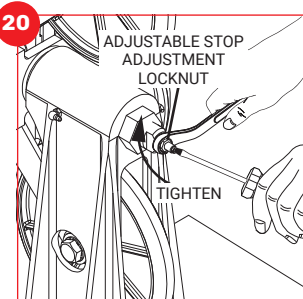

When the desired amount of postwise float is set, tighten locknut securely while holding adjustable stop screw in place. **If installing guides equipped with polyurethane roller wheels, refer to step 21 for pertinent information.**

21 ELSCO's polyurethane roller wheels are a hard (95 Shore A durometer) polymer material intended for use on lower speed elevators when the roller wheel pressures exceed those specified for neoprene composition wheels (25-50 lb, or 12-25 kg).

While polyurethane roller wheels can operate at pressures up to 300 lbs (140 kg) per wheel, it is advisable to keep static pressure as low as possible to prevent flat spots from forming while the elevator is sitting. Flat spots can adversely affect ride quality by causing a rough and/or noisy ride. At higher pressures, it may not be possible to skid the roller wheels by hand.

22 After all adjustments have been made, ride elevator in both the up and down direction at inspection speed to check hoistway clearances. Check to be sure that all mounting bolts and/or nuts, and adjustment locknuts are securely tightened. Make several more runs at operating speed, then recheck float, tracking and roller wheel pressures before returning elevator to service.

EXPRESS-6 ROLLER GUIDE SERVICE PARTS LIST

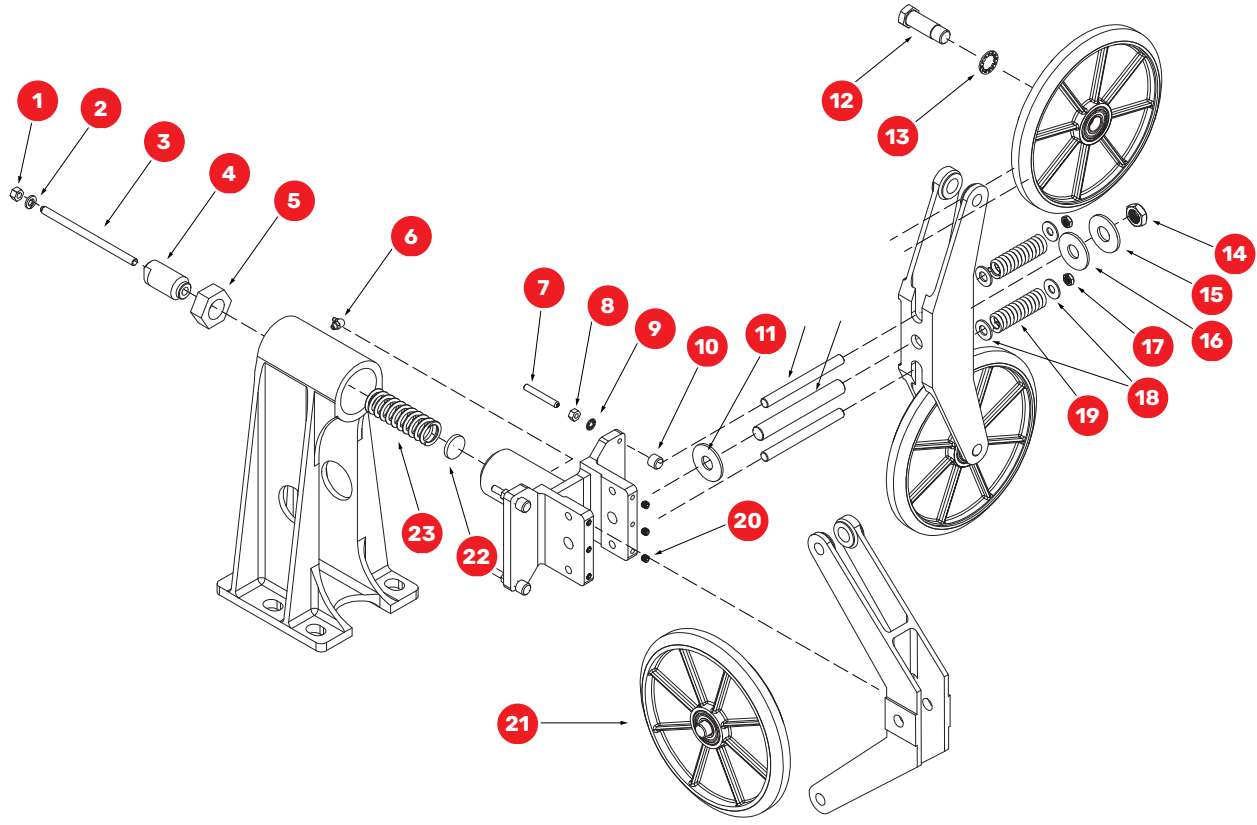

KEY	QTY	PART #	DESCRIPTION
1	1	EA18329	Hex Nut
2	1	EA18330	Lock Washer
3	1	EA18326	Adjustable Stop Adjustment Screw
4	1	EA18327	Hub Adjustment Screw
5	1	EA19763	Hub Adjustment Locking Nut
6	1	EA18362	Grease Fitting
7	4	EA19387	Side Arm Tracking Screw
8	4	EC18428	Hex Nut
9	4	EF04131	Lock Washer
10	4	EX02020	EX02020 Tracking Screw End Pad
11, 16	4	EA18378	Rubber Washer
12	6	EX02013	Wheel Stud
13	6	EA18388	Wheel Stud Lock Washer
14	2	EA18376	Locknut
15	2	EA18373	Flat Washer
17	4	EC18422	Locknut
18	8	EX02026	Flat Washer
19	4	EX02025	Side Arm Spring

KEY	QTY	PART #	DESCRIPTION
20	6	EA19765	Set Screw
21	6	See Roller Wheel Configuration Options	
22	1	EA18328	Solid Stop Washer
23	1	EA18380	Hub Spring

ROLLER WHEEL CONFIGURATIONS

Typical Installations

ASSEMBLY	QTY	PART #	DESCRIPTION
EX02000	6	EX02002	10" Black Neoprene Roller Wheel

◆ Parts can be ordered together as a replacement kit under part #EA18331