

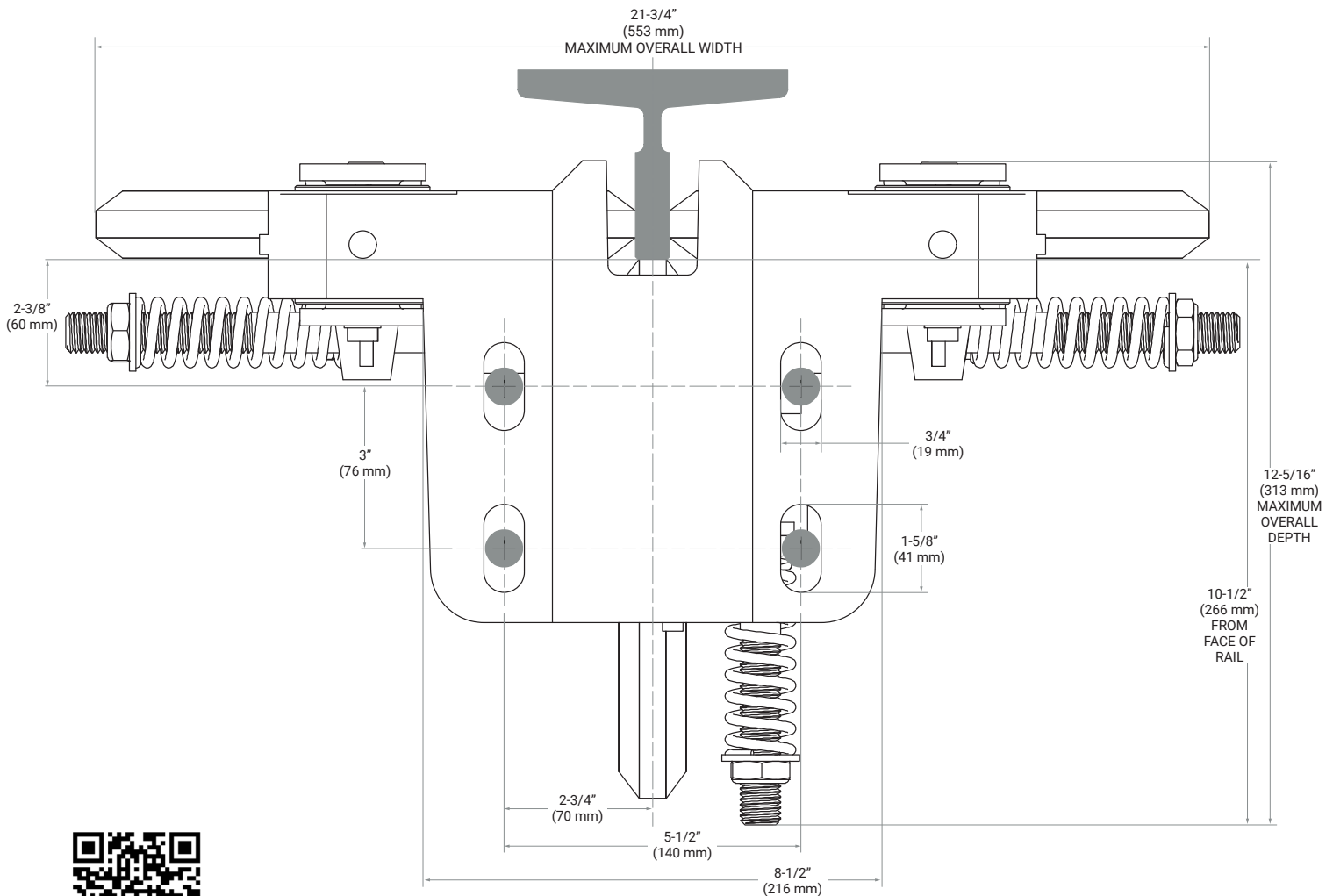

# EXPRESS 3

## MOUNTING SPECIFICATIONS



Drawing not to scale.  
Scan here for a full-scale  
printable template.

## The Next Level in Ride Quality

Designed for elevator cars up to 2,000 fpm or 5,000 lbs capacity in high-rise buildings.

If the bolt pattern above does not line up exactly with your mounting pattern, **Flex-Mount™ Adjustable Adapter Plates** are the best time-saving, and money-saving solution. Contact us to find out more.

**INSTALLATION INSTRUCTIONS**

ELSCO Express-3 elevator roller guides are designed with adjustment features that provide superior riding characteristics. The installer can easily adjust ELSCO guides to compensate for adverse operating conditions and to minimize noise, bumps and vibration. For optimum performance and longer roller wheel life, we recommend that elevator rails be properly aligned and cleaned, and the car balanced before operation.

ELSCO roller guides are carefully assembled, inspected, and packed to arrive in perfect condition. When your shipment arrives, inspect it carefully for damage and, if appropriate, immediately file a claim with the carrier. For best results, read all instructions thoroughly before proceeding with the installation.

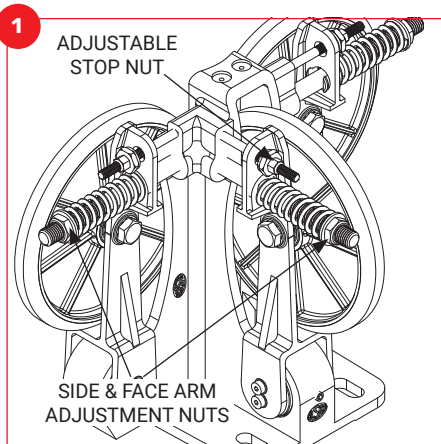

The Express-3 roller guide comes completely assembled.

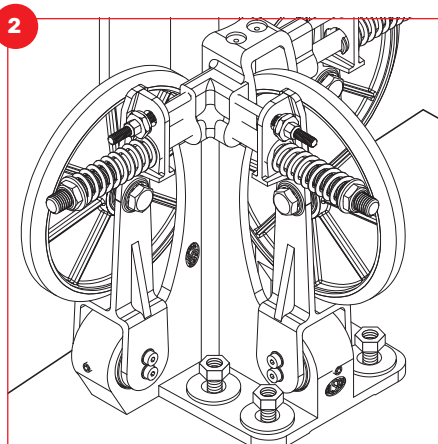

Begin by securing all four roller guides to the car frame. Starting with either top roller guide, position guide base over mounting holes or studs. Install mounting hardware (not included).

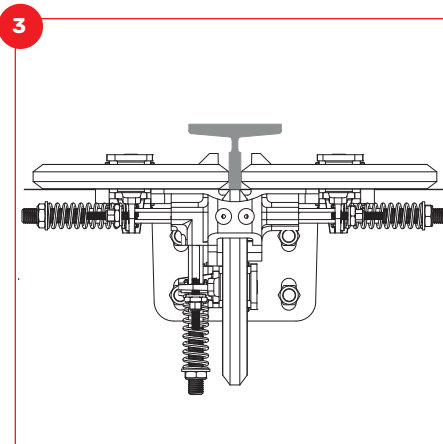

Position guide with the tread of face roller centered on rail as shown above. Be sure that guides are aligned properly (as shown) before making any further adjustments.

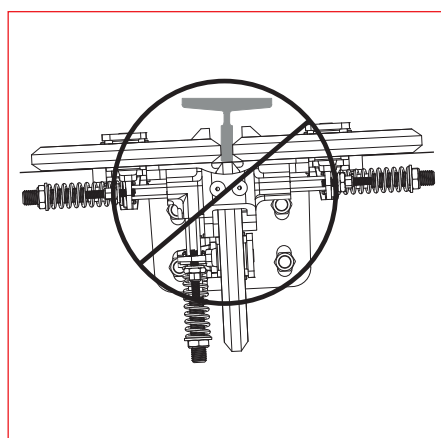

Improper alignment.

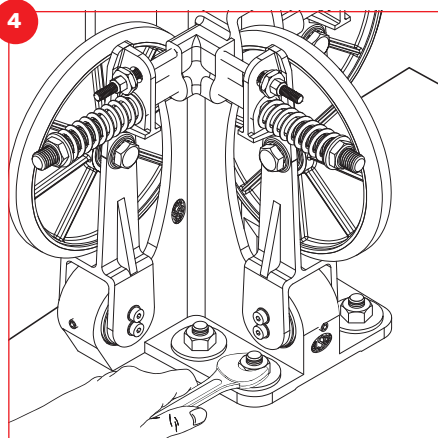

Securely tighten the mounting bolts and/or nuts. Before making any adjustments, install all remaining roller guides by securing them to the car frame as shown in steps 2-4.

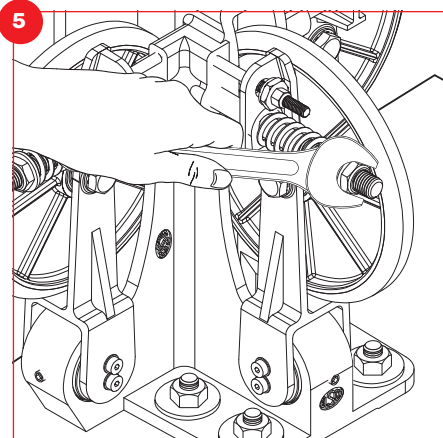

Begin adjustment with the top two roller guides. Using the side and face arm adjustment nuts, tighten all three roller wheels on one guide so that each just touches the rail. There should be no pressure exerted on the rail at this point. **Repeat step 5 on the opposite top roller guide.**

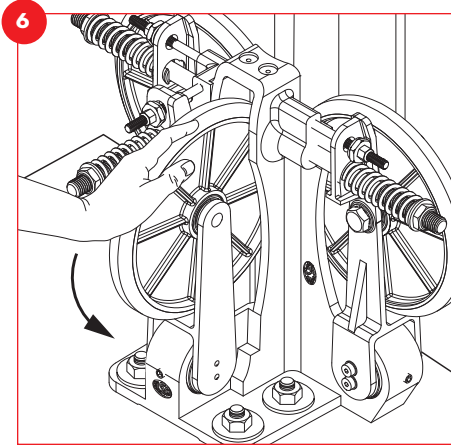

Tighten one face roller by 2 full turns of the face arm adjustment nut. Repeat on the opposite face roller. At this point, each face roller should exert 25-50 lbs (12-25 kg) pressure against the face of each rail. It will be possible to skid the face roller wheel by hand with moderate effort. Be certain that the face roller wheel pressures are equal for each guide; adjust as necessary.

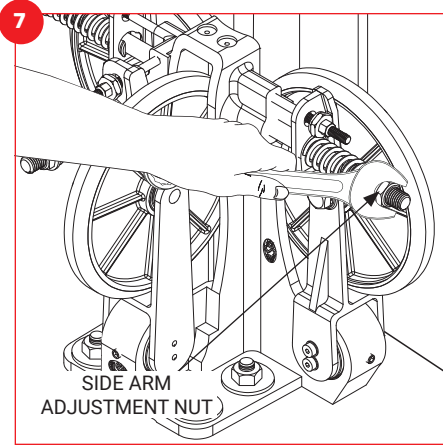

Adjust side roller wheel pressure. Turn the side arm adjustment nuts 2 full turns on each side of the roller guide. The face arm wheels should be tracking in the center of the rail. This represents approximately 25-50 lbs (12-25 kg) of wheel pressure on each side arm wheel. **Repeat on the opposite side roller guide.**

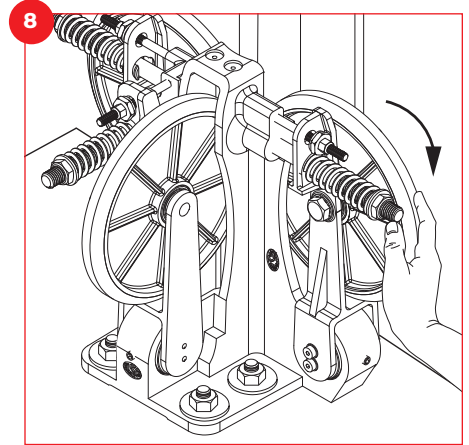

When properly adjusted, it will be possible to skid the side arm roller wheels by hand with moderate effort.

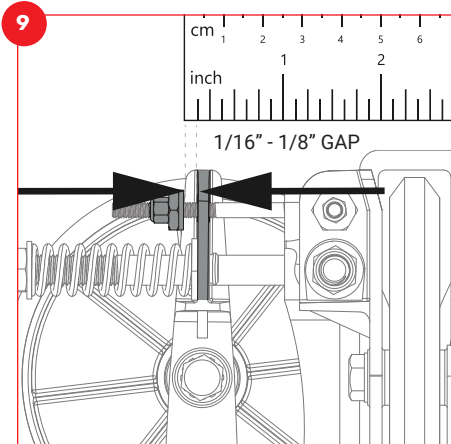

Turn the adjustable stop nut to increase or decrease the gap between the arm and the rubber surface of the adjustable stop nut to achieve the desired float. Recommended gap adjustment is 1/16" - 1/8" (1.5 - 3.0 mm). Lock adjustable stop nut in place by tightening the supplied lock nut.

**10** Repeat step 9 for all three adjustable stops on each top roller guide.

**11** Repeat steps 5-10 on the bottom two roller guides.

**12** After all adjustments have been made, ride elevator in both the up and down direction at inspection speed to check hoistway clearances. Check to be sure that all mounting bolts and/or nuts are securely tightened. Make several more runs at operating speed, then recheck float (if applicable), tracking, and roller wheel pressures before returning elevator to service.

**EXPRESS-3 ROLLER GUIDE SERVICE PARTS LIST**

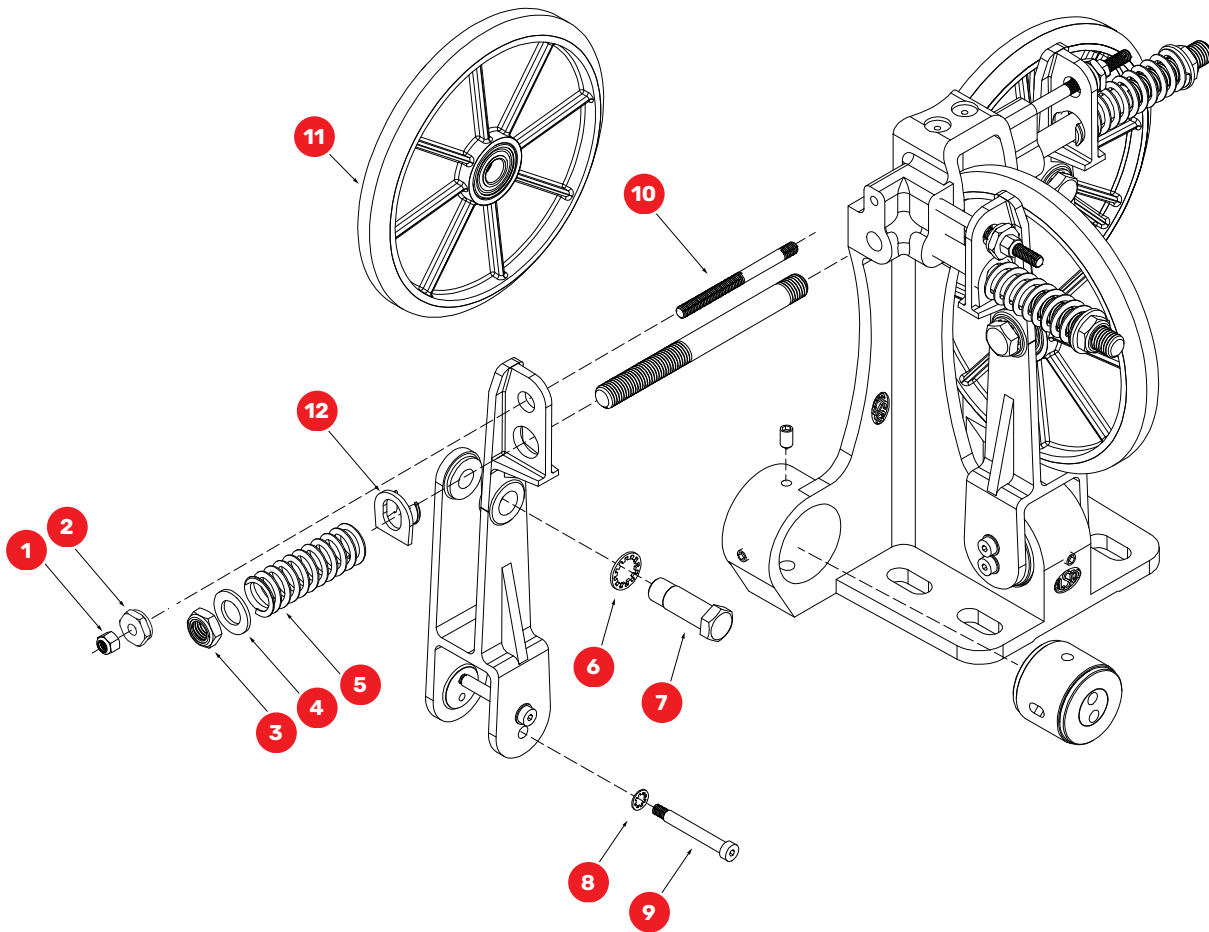

KEY	QTY	PART #	DESCRIPTION
1	3	3100154	Locking Hex Nut
2	3	EY02011	Adjustable Stop Nut
3	3	EY02034	Locknut
4	3	EY05002	Flat Washer
5	3	EY02033	Side/Face Arm Spring
6	3	EA18388	Lock Washer
7	3	EX02013	Wheel Stud
8	6	EB02116	Lock Washer
9	6	EY05004	Screw
10	3	EY02032	Adjustable Stop Stud
11	3	See Roller Wheel Configurations	
12	3	EY02055	Arm Bushing

**ROLLER WHEEL CONFIGURATIONS**

Typical Installations

ASSEMBLY	QTY	PART #	DESCRIPTION
EY02010	3	EX02002	10" Black Neoprene Roller Wheel